

Model 340 Input Option Card Installation

Field Installation

Input option card kit:

- (1) 10-conductor ribbon cable
- (1) Option card
- (4) 32 mm (1.25 in) metal standoffs
- (8) 4-40 machine screws

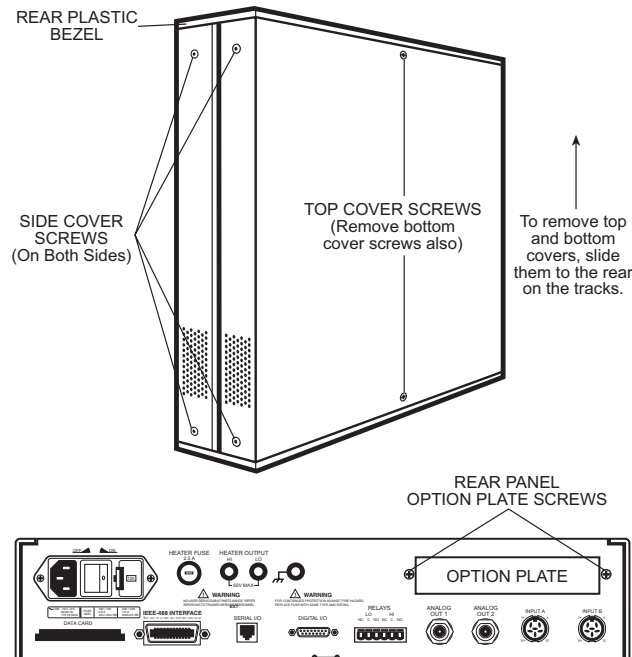

Figure 1. Cover and Option Plate Screws

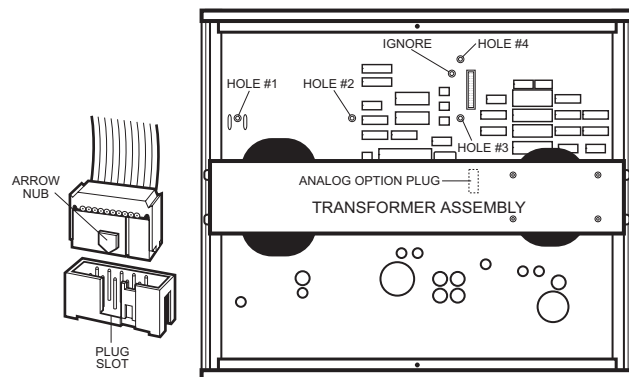

Figure 2. Model 340 Mounting Holes and Analog Option Plug

These instructions apply to 3462, 3464, 3465, and 3468 option cards

Required tools: Small Phillips-head screwdriver and 5/64-inch Allen wrench

CAUTION: The components on this board are electrostatic discharge sensitive (ESDS) devices. Wear shock-proof wrist straps (resistor limited to <math><5\text{ mA}</math>) to prevent injury to service personnel and to avoid inducing an electrostatic discharge (ESD) into the device.



1. Turn Model 340 power switch OFF. Unplug power cord from wall outlet, then instrument.
2. Stand the unit on its face. Use the Allen wrench to remove the 4 screws on each side of the covers (Figure 1).
3. Use the small Phillips screwdriver to remove any top and bottom cover screws; instrument may have 1 or 2 screws on the top and bottom covers.
4. Remove rear plastic bezel. The covers are tracked. Slide the top and bottom covers to the rear on the tracks to remove them.
5. Remove rear panel option plate screws and set aside. Remove rear panel option plate.
6. With the instrument still standing on its face, turn it to view the inside circuit board. The upper half of the circuit board above the transformer assembly contains four holes where metal standoffs install (Figure 2).
 Find Hole #1 to the left between C245 and C265.
 Find Hole #2 114 mm (4.5 in) to the right of Hole #1, and just to the left of C298 and U154.
 Find Hole #3 114 mm (4.5 in) to the right of Hole #2, and just to the left and below the Digital Option plug (J9).
 Find Hole #4 64 mm (2.5 in) above Hole #3, just to the left and above the digital option plug (J9). Ignore hole to left and beneath Hole #4.
 Into each hole, insert a 4-40 screw through the bottom of the circuit board, and thread it into a metal standoff on the top of the circuit board.

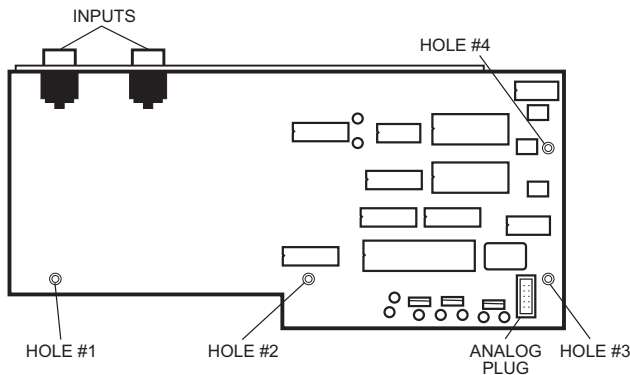

Figure 3. Option Card Mounting Holes and Analog Plug

7. Just beneath the transformer assembly is the analog option plug (J18). Plug either end of the ribbon cable into the analog option plug (J18). Slide the arrow nub into the plug slot for correct positioning (Figure 2).
8. Plug the other end of the ribbon cable into the option card plug (J3), on the lower right corner of the card (Figure 3).
9. Place the option card on top of the metal standoffs in the instrument. Fit the card sensor inputs out the rear panel option opening. Retrieve option plate screws from Step 5 and use to slightly tighten the option card to the rear panel.
10. Align the holes in the card with the corresponding metal standoffs. Insert a 4-40 screw through each option card hole and thread it to the metal standoff beneath. Go back and tighten the two screws securing the option card to the rear panel.
11. Stand instrument on face. Slide top and bottom covers on. Reposition rear plastic bezel, then rethread all cover screws. The completed installation of the 3462 card should look like Figure 4. (Others will look similar.)
12. Replace power cord. Turn on power switch. To verify option card installation, press **Options**, then press **More** three times. The Model 340 displays the option in the REVISION INFORMATION.

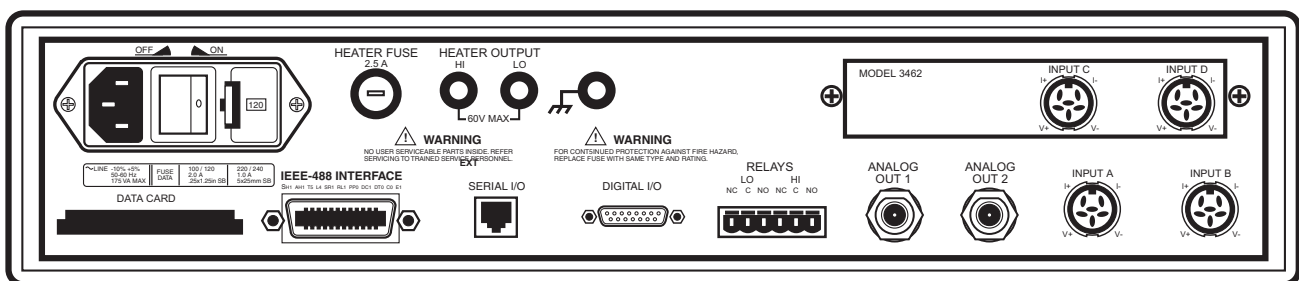

Figure 4. Model 340 Rear Panel with Model 3462 Option Card Installed